

# Lancaster High School



**2017**  **2018**

**44701 North 32<sup>nd</sup> Street, West**

**Lancaster, CA 93536**

**Phone #: (661)726-7649**

**Fax: (661) 726-7694**

**Web Site: [www.lnhs.org](http://www.lnhs.org)**

This handbook is designed to provide an overview of Lancaster High School and is intended to explain the basic policies, procedures, and programs. Please use it to become familiar with the guidelines, services, and opportunities provided by the school. Students are accountable for the information contained in this handbook. If you have any further questions, you are welcome to contact a counselor, staff member, or administrator.

## TABLE OF CONTENTS

---

|  |    |
|--|----|
| School Map   | 1  |
| Lancaster High School Administration                                   | 2  |
| Principal's Message; Vision; Mission                                   | 2  |
| Character Counts   | 3  |
| REAL Eagles  | 4  |
| Important Telephone Numbers  | 5  |
| Important Dates  | 7  |
| PowerSchools   | 9  |
| Notes from the Attendance Office                                       | 10 |
| Four-Year Student Educational Plan                                     | 11 |
| University of California A-G Requirements                              | 12 |
| Student Services (Guidance)  | 13 |
| Student Codes of Conduct (Attendance)                                  | 13 |
| 5-Day Attendance Policy  | 14 |
| Voluntary Saturday School Program                                      | 14 |
| Operation D.A.R.T (Truancy)  | 15 |
| Tardy Policy   | 16 |
| Student Identification Cards   | 17 |
| Discipline Policy  | 18 |
| District Dress Code and Gang Dress Policy                              | 20 |
| Sometimes You Need Some Help<br><i>(Emergency and Hotline Numbers)</i> | 21 |
| Clubs and Activities   | 22 |
| Clubs on Campus; CSF Information                                       | 23 |
| Co-Curricular Programs   | 24 |
| Athletics  | 25 |
| Campus Policy & Civility Policy  | 26 |

# Lancaster Boulevard

Lancaster High School  
 44701 North 32nd Street West  
 Lancaster, CA 93536  
 (661)726-7649

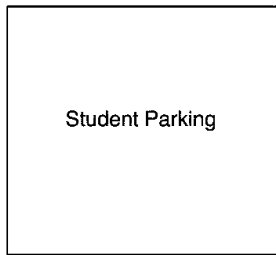
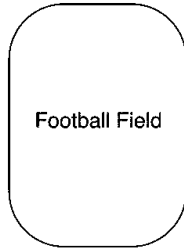

32nd Street West

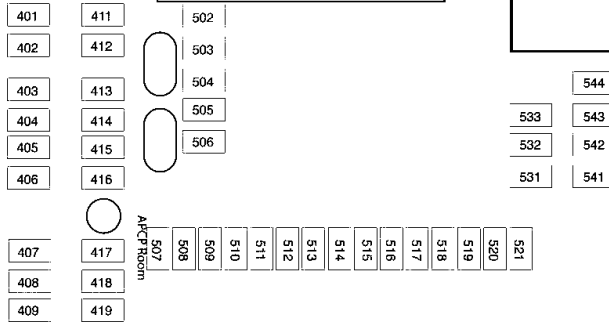
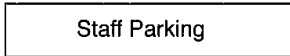
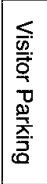
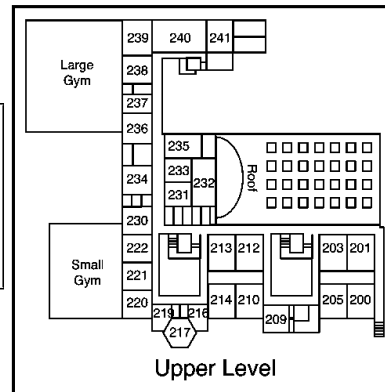
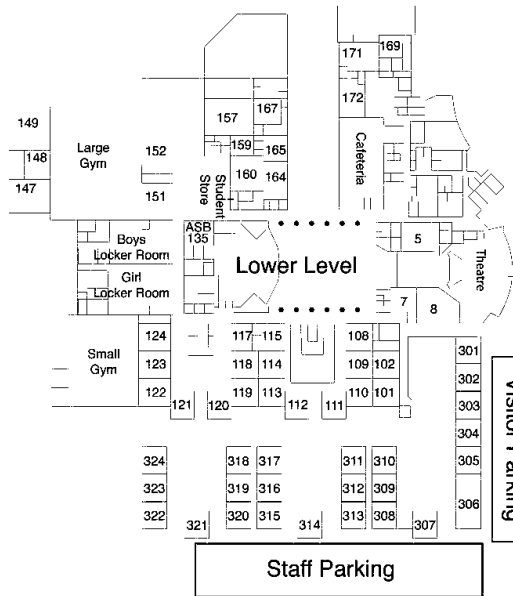

## **LANCASTER HIGH SCHOOL ADMINISTRATION**

|   |                |
|---|----------------|
| <b>Principal</b>                          | Dr. Tepper     |
| <b>Assistant Principal</b>                | Ms. Morgan-Kim |
| <b>Vice Principal - Activities</b>        | Mr. Blanton    |
| <b>Vice Principal - Athletics</b>         | Mr. Dunn       |
| <b>Vice Principal – Student Services</b>  | Mr. Kleespies  |
| <b>Vice Principal - Special Education</b> | Ms. Parsons    |
| <b>Head Counselor</b>                     | Mr. Anderson   |
| <b>Director of Security</b>               | Mr. Bryant     |

### **PRINCIPAL’S MESSAGE**

Welcome to the 2017 – 2018 school year. This handbook is designed to provide an overview of Lancaster High School and is intended to explain the basic policies, procedures, and programs. I challenge each student to do their best, get involved and be a REAL Eagle.

### **VISION STATEMENT**

The vision of Lancaster High School is to empower our students to become personally and socially responsible members of society who are equipped for post-secondary education, the workforce, and all challenges of the twenty-first century

### **MISSION STATEMENT**

Working in partnership with all stakeholders, Lancaster High School will use the best instructional practices and curriculum to provide a safe environment, and ensure all students grow towards academic achievements, emotional maturity, physical well-being, and social responsibility.

## **CHARACTER COUNTS AT LANCASTER HIGH SCHOOL**

**Trustworthiness    Respect    Responsibility**  
**Fairness    Caring    Citizenship**

### **Trustworthiness**

Be honest • Don't deceive, cheat or steal • Be reliable – do what you say you'll do • Have the courage to do the right thing • Build a good reputation • Be loyal – stand by your family, friends and country

### **Respect**

Treat others with respect; follow the Golden Rule • Be tolerant of differences • Use food manners, not bad language • Be considerate of the feelings of others • Don't threaten, hit or hurt anyone • Deal peacefully with anger, insults and disagreements

### **Responsibility**

Do what you are supposed to do • Persevere: keep on trying! • Always do your best • Use self-control • Be self-disciplined • Think before you act – consider the consequences • Be accountable for your choices

### **Fairness**

Play by the rules • Take turns and share • Be open-minded; listen to others • Don't take advantage of others • Don't blame others carelessly

### **Caring**

Be kind • Be compassionate and show you care • Express gratitude • Forgive others • Help people in need

### **Citizenship**

Do your share to make your school and community better • Cooperate • Get involved in community affairs • Stay informed; vote • Be a good neighbor • Obey the laws and rules • Respect authority • Protect the environment

# REAL EAGLES

*are prepared to be:*

## **R**ESPONSIBLE CITIZENS WITH THE ABILITY TO

- Respect different viewpoints and reasoning processes
- Understand the principles of democracy
- Work with a diversity of people
- Contribute to the betterment of their school and community

## **E**FFECTIVE COMMUNICATORS WITH THE ABILITY TO

- Speak effectively
- Read critically
- Write clearly

## **A**NALYTICAL THINKERS WITH THE ABILITY TO

- Distinguish fact from opinion
- Solve problems logically
- Utilize information from a variety of sources
- Use technology as a tool

## **L**IFE-LONG LEARNERS WITH THE ABILITY TO

- Practice self-directed learning
- Plan for possible careers
- Access needed information and databases
- Work both collaboratively and individually
- Accept responsibility for their actions

## IMPORTANT TELEPHONE NUMBERS

Main Line.....726-7649

Fax Line.....726-7694

**Dial 726-7649; when connected to school's main line, dial the extension number.**

### ADMINISTRATION

|  |                    |     |                        |
|--|--------------------|-----|------------------------|
| Principal                              | Dr. Kristen Tepper | 192 | ktepper@avhdsd.org     |
| Secretary                              | Laura Stutzman     | 192 | lstutzman@avhdsd.org   |
| Receptionist (Lobby)                   | Cynthia Rossi      | 800 | crossi@avhdsd.org      |
| Assistant Principal                    | Jo Morgan-Kim      | 786 | jokim@avhdsd.org       |
| Secretary                              | Carol Lowe         | 786 | clowe@avhdsd.org       |
| Vice Principal of Activities           | Peter Blanton      | 789 | pblanton@avhdsd.org    |
| Secretary                              | Gail Berry         | 789 | gberry@avhdsd.org      |
| Vice Principal of Athletics            | Lloyd Dunn         | 784 | ladunn@avhdsd.org      |
| Secretary                              | Michele Polizzi    | 784 | mpolizzi@avhdsd.org    |
| Vice Principal of<br>Special Education | Michelle Parsons   | 189 | mparsons@avhdsd.org    |
| Secretary                              | TBD                | 116 |                        |
| Vice Principal of<br>Student Services  | John Kleespies     | 189 | jkleespies@avhdsd.org  |
| Secretary                              | Melissa Baranowski | 189 | mbaranowski@avhdsd.org |

### ATHLETICS

|                   |             |     |                   |
|-------------------|-------------|-----|-------------------|
| Athletic Director | Cumby Jones | 122 | cjones@avhdsd.org |
|-------------------|-------------|-----|-------------------|

### ATTENDANCE OFFICE

|              |               |     |                     |
|--------------|---------------|-----|---------------------|
| Clerk, (A-L) | Robyn Metzger | 798 | rmetzger@avhdsd.org |
| Clerk, (M-Z) | Tamera Carbo  | 799 | tcarbo@avhdsd.org   |

### CAFETERIA OFFICE

|         |                   |     |                      |
|---------|-------------------|-----|----------------------|
| Manager | Tristina Williams | 768 | twilliams@avhdsd.org |
|---------|-------------------|-----|----------------------|

### COMMUNITY ATTENDANCE WORKER (Truancy)

|     |               |     |                    |
|-----|---------------|-----|--------------------|
| CAW | Denise Weaver | 229 | dweaver@avhdsd.org |
|-----|---------------|-----|--------------------|

### COUNSELING OFFICE

|                     |                  |     |                       |
|---------------------|------------------|-----|-----------------------|
| Head Counselor      | Jef Anderson     | 782 | janderson@avhdsd.org  |
| Counselors          | Fran Beckerman   | 751 | fbeckerman@avhdsd.org |
|                     | Melody Briseño   | 754 | mbrisenos@avhdsd.org  |
|                     | Barbara Frazier  | 756 | bfrazier@avhdsd.org   |
|                     | Gretchen Teaney  | 753 | gteaney@avhdsd.org    |
|                     | Melissa Vattioni | 755 | mvattioni@avhdsd.org  |
| Pupil Services Tech | Marie Boehm      | 781 | mboehm@avhdsd.org     |
| Pupil Services Tech | Linda Brown      | 797 | librown@avhdsd.org    |
| Guidance Clerk      | Sydney Bleicher  | 757 | sbleicher@avhdsd.org  |

### HEALTH OFFICE

|                |                   |     |                       |
|----------------|-------------------|-----|-----------------------|
| District Nurse | Geri Chandler     | 731 | gchandler@avhdsd.org  |
| Health Clerk   | Theresa Rodriguez | 176 | trodriguez@avhdsd.org |

**INDEPENDENT STUDY OFFICE**

|                         |                 |     |                      |
|-------------------------|-----------------|-----|----------------------|
| Independent Study Clerk | Eva Mendez      | 542 | emendez@avhsd.org    |
| Learning Center Tech    | William Daubert | 306 | wdaubert@avhsd.org   |
| Teacher                 | John Bacchus    | 682 | jbacchus@avhsd.org   |
| Teacher                 | Mark Burnstein  | 171 | mburnstein@avhsd.org |
| Teacher                 | Julie Milburn   | 685 | jmilburn@avhsd.org   |
| Teacher                 | Robin Manjarrez | 175 | rmanjarrez@avhsd.org |

**LIBRARY**

|                    |                        |     |                          |
|--------------------|------------------------|-----|--------------------------|
| Library Media Tech | Jennifer Harmon-Grieve | 128 | jharmon-grieve@avhsd.org |
|--------------------|------------------------|-----|--------------------------|

**MAINTENANCE OFFICE**

|                |                 |     |                      |
|----------------|-----------------|-----|----------------------|
| Maintenance I  | Chuck Bryan     | 156 | cbryan@avhsd.org     |
| Maintenance II | Chris Plasencia | 156 | cplasencia@avhsd.org |

**PSYCHOLOGIST**

|              |                      |     |                     |
|--------------|----------------------|-----|---------------------|
| Psychologist | Oscar Mora (A-L)     | 383 | mjustice@avhsd.org  |
| Psychologist | Brett Vedomske (M-Z) | 372 | bvedomske@avhsd.org |

**REGISTRAR (School Records, Transcripts)**

|           |               |     |                    |
|-----------|---------------|-----|--------------------|
| Registrar | Stacy Berumen | 183 | sberumen@avhsd.org |
|-----------|---------------|-----|--------------------|

**SCHOOL ACCOUNTANT**

|                      |               |     |                    |
|----------------------|---------------|-----|--------------------|
| Site Accountant Tech | Pilar Mendoza | 796 | pmendoza@avhsd.org |
|----------------------|---------------|-----|--------------------|

**SCHOOL DEPUTY**

|             |               |     |                     |
|-------------|---------------|-----|---------------------|
| Site Deputy | Andy Guardado | 772 | aguardado@avhsd.org |
|-------------|---------------|-----|---------------------|

**SECURITY**

|          |              |     |                   |
|----------|--------------|-----|-------------------|
| Director | Kenny Bryant | 769 | kbryant@avhsd.org |
|----------|--------------|-----|-------------------|

**STUDENT STORE**

|           |                |     |                    |
|-----------|----------------|-----|--------------------|
| ASB Clerk | Gloria Herrera | 161 | gherrera@avhsd.org |
|-----------|----------------|-----|--------------------|

**VOLUNTEER COORDINATOR**

|                  |                    |     |                       |
|------------------|--------------------|-----|-----------------------|
| Site Coordinator | Melissa Baranowski | 189 | mbaranowski@avhsd.org |
|------------------|--------------------|-----|-----------------------|

**PARENT INFORMATION**

**Messages:** Lancaster High School staff will not deliver messages to students in class. In the case of an emergency, please contact your student's Vice Principal to discuss the situation and option of delivering a message.

**Delivering Items:** Lancaster High School staff will not deliver gifts, balloons, flowers, food, or other items to students. Students are not allowed to bring balloons, pies, cakes, cupcakes, or whole pizzas onto campus.





## **IMPORTANT DATES**



**2017 – 2018**

|   |   |
|---|---|
| Link Crew Freshman Orientation  | August 1 <sup>st</sup>                    |
| First Day of School   | August 7 <sup>th</sup>                    |
| Freshman & Faculty Picture Day (Small Gym)  | August 17 <sup>th</sup>                   |
| Student Make-Up & Faculty Picture Day (Small Gym)                                       | August 18 <sup>th</sup>                   |
| Back to School Night  | September 7 <sup>th</sup>                 |
| College Night at A. V. Fairgrounds 4:30p-7:30p  | September 25 <sup>th</sup>                |
| Class Ring Order Days (Stage in Quad both lunches)                                      | October 5 <sup>th</sup> & 6 <sup>th</sup> |
| Homecoming (Game) vs Highland High School   | October 6 <sup>th</sup>                   |
| Homecoming (Dance) Lg. Gym 7:00p-11:00p   | October 7 <sup>th</sup>                   |
| Graduation Cap & Gown Order Day (Theater)   | Nov. 2 <sup>nd</sup> & 3 <sup>rd</sup>    |
| Back to School Night  | January 31 <sup>st</sup>                  |
| Student Picture Days (for 2018-2019 school year)  | March 29 <sup>th</sup> & 30 <sup>th</sup> |
| PROM at Madame Tussauds - Hollywood   | April 7 <sup>th</sup>                     |
| Grad Nite – Universal Studios   | May 18 <sup>th</sup>                      |
| Graduation 6:00pm @ Lou Bozigian Football Stadium                                       | May 30 <sup>th</sup>                      |
| Last Day of School (for 9 <sup>th</sup> , 10 <sup>th</sup> , & 11 <sup>th</sup> grades) | May 31 <sup>st</sup>                      |

### **MINIMUM DAYS**

|                                 |   |
|---------------------------------|---|
| Back to School Night            | Sept 7 <sup>th</sup> & Jan 31 <sup>st</sup> |
| 1 <sup>st</sup> Semester Finals | December 13 <sup>th</sup> -15 <sup>th</sup> |
| 2 <sup>nd</sup> Semester Finals | May 29 <sup>th</sup> – May 31 <sup>st</sup> |

### **FLEX & STAFF DAYS – Dismissal at 1:16p**

Aug. 7, 16, 23 & 30, Sep. 6, 13, 20 & 27, Oct. 4, 11 & 18, Nov. 1, 15 & 29, Dec. 6, Jan. 10 & 24, Feb. 28, Mar. 8, 14 & 28, Apr. 4, 18 & 25, May 2, 9, 16 & 23

### **PROF. DEVELOPMENT DAYS – No School**

Oct. 25, Feb. 7, Apr. 11, and Jun. 1

### **TESTING REGISTRATION DEADLINES AND TESTING DATES**

#### **AP Test Dates - 1<sup>st</sup> Week (May 7<sup>th</sup> - 11<sup>th</sup>), 2<sup>nd</sup> Week (May 14<sup>th</sup> -18<sup>th</sup>)**

**See AP Coordinator for ordering deadline.**

#### **Week 1**

- May 7** - Chemistry, Spanish Lit/Cul (a.m.) & Psychology (p.m.)
- May 8** - Spanish Lit/Cul (a.m.) & Art History & Physics 1 (p.m.)
- May 9** - English Literature & Comp (a.m.) & Physics 2 (p.m.)
- May 10** - U. S. Government & Politics (a.m.) & Envi. Sci. (pm.)
- May 11** - U.S. History (a.m.) & Computer Science (pm.)  
Studio Art & 2-D Design (Portfolios Due)(p.m.)



## **IMPORTANT DATES**

**2017 – 2018**

**(continued)**



### **AP Tests Dates (continued)**

#### **Week 2**

**May 14** - Biology (a.m.) Physics C (p.m.)

**May 15** - Calculus AB & Cal BC (a.m.) & French & Computer Sci. (p.m.)

**May 16** - English Lang. & Comp (a.m.)

**May 17** - Gov. and Politics & World History (a.m.) & Statistics (p.m.)

**May 18** - No Testing

**ASVAB** Test Dates (in Library)(Juniors) TBD

**PSAT** Test Date (ASVAB for Seniors) October 13<sup>th</sup>

**CASSPP** Test Dates April 9<sup>th</sup> – 27<sup>th</sup>

**FITNESS TESTING** March thru April

**END OF QUARTER:** Determines Eligibility for Athletes & Activities  
**(Fall Semester)** Oct. 6<sup>th</sup>, Dec. 15<sup>th</sup> **(Spring Semester)** Mar. 16<sup>th</sup>, Jun. 1<sup>st</sup>

### **SCHOOL HOLIDAYS AND BREAKS**

|                             |  |               |
|-----------------------------|--|---------------|
| Labor Day                   | September 4 <sup>th</sup>                          | Monday        |
| Veteran's Day               | November 10 <sup>th</sup>                          | Friday        |
| Thanksgiving Break          | November 20 <sup>th</sup> -24 <sup>th</sup>        | Monday–Friday |
| Winter Break                | December 18 <sup>th</sup> –January 5 <sup>th</sup> | 3 weeks       |
| Martin Luther King, Jr. Day | January 15 <sup>th</sup>                           | Monday        |
| Lincoln's Day               | February 12 <sup>th</sup>                          | Monday        |
| President's Day             | February 19 <sup>th</sup>                          | Monday        |
| Spring Break                | March 19 <sup>th</sup> – 23 <sup>rd</sup>          | Monday–Friday |
| Memorial Day                | May 28 <sup>th</sup>                               | Monday        |

**SUMMER SCHOOL** TBA

## **POWERSCHOOL**

Welcome to PowerSchool's parent portal, where parents are connected to real-time classroom information related to their child.

PowerSchool's Parent Portal gives parents and students access to real-time information including attendance, grades and detailed assignment descriptions, school bulletins, lunch menus and even personal messages from the teacher. Everyone stays connected: Students stay on top of assignments, parents are able to participate more fully in their student's progress, and teachers can use their grade book to make decisions on what information they want to share with parents and students.

Features:

- View real-time grades and attendance
- Teacher comments
- Grade History
- Graduation Progress
- Change Passwords
- Get e-mail notifications, daily, weekly, monthly

### **How to Log In to PowerSchool's Parent Portal**

1. Open your Web browser to your school's PowerSchool Parent Portal URL <https://powerschool.avhsd.org> The Log In page appears.
2. Enter your username in the first field.
3. Enter your password in the second field.

**Note:** The characters appear as asterisks (\*) to ensure greater security when you log in.

4. Click **Sign In**. The PowerSchool Parent Portal start page appears. For more information, see *PowerSchool Parent Portal Start Page*.

**Note:** Do not use someone else's password or give your password to anyone else.

\*\*All student data is stored on the District's internal secured servers.

## **NOTES FROM THE ATTENDANCE OFFICE**

***Please make sure your emergency cards are updated and on file with the attendance office.***

### **Off-Campus Pass**

Students may not leave campus for any reason without an off-campus pass. Off campus requests must be in writing to the Attendance office. Students may bring the note either before school or at snack. All requests will be verified prior to release of the student. Parents are welcome to come to the attendance office to sign their student out with proper ID.

When picking up a student:

1. You must have Photo I.D.
2. You must be a Parent/Guardian/Emergency Card
3. You must come to attendance window
4. **Students will not be released via phone call requests.**

If you are unable to pick up a Student, the person who comes to pick them up:

1. Must be 18 Years Old
2. Must have Photo I.D.
3. Must be listed on Emergency Card
4. Must not be a current LnHS Student

If withdrawing a student from school (checking out), you will need:

1. To go to Attendance Office
2. Photo I.D.
3. Only a parent/guardian may withdraw a student; proof that you are the parent/guardian is required.

Students returning to school after an appointment with the doctor, dentist, etc., Must bring a pass from the office they have visited or the pink "Off-Campus Pass" they left school with or they will be referred to the Security Office for a Tardy Pass. All doctor's notes, attendance notes, and verification will be handled through the Attendance Office.

## **PHYSICAL EDUCATION UNIFORM POLICY**

Physical Education students need to bring and wear Lancaster High School Physical Education clothing, including sock and athletic shoes that lace. If a student has difficulty purchasing the proper clothing they need to speak to their teacher. The LnHS Physical Education clothing can be purchased from the STUDENT STORE. (Checks are made payable to LnHS, and must have the driver's license# and expiration date. Credit cards may be used by the card holder only.

The cost for the set of shirt and a pair of shorts is **\$21.85** (shirt \$9.00 + tax, shorts \$11.00 + tax). The student's name is required to be on the shorts and shirt. Students must also provide their own LOCK.

**2017 - 2018**  
**Four-Year Student Educational Plan**

Below you will find sample guidelines for customizing steps to the next level. Whatever plan you choose should remain flexible and can be altered if goals change. Counselors are available to help develop this plan.

Community College / Military / Vocational Training Model

| <u>9<sup>th</sup> Grade</u> | <u>10<sup>th</sup> Grade</u> | <u>11<sup>th</sup> Grade</u> | <u>12<sup>th</sup> Grade</u> |
|-----------------------------|------------------------------|------------------------------|------------------------------|
| English 9                   | English 10                   | English 11                   | Expo. Read. & Writing        |
| Algebra 1                   | Geometry                     | Algebra 2                    | Civics/Economics             |
| Health                      | World History                | US History                   | Elective                     |
| Biology                     | Chemistry                    | Elective                     | Elective                     |
| P.E. 1                      | P.E. 2                       | Elective                     | Elective                     |
| Elective                    | Elective                     | Elective                     | Elective                     |

CSU University / Private University Model

| <u>9<sup>th</sup> Grade</u> | <u>10<sup>th</sup> Grade</u> | <u>11<sup>th</sup> Grade</u> | <u>12<sup>th</sup> Grade</u> |
|-----------------------------|------------------------------|------------------------------|------------------------------|
| English 9 or Honors         | English 10 or Honors         | English 11 or AP             | Expo Read & Writing          |
| Algebra 1                   | Geometry                     | Algebra 2                    | /AP Lit & Comp               |
| Health                      | World History or AP          | US History or AP             | Trig/PreCalculus             |
| Biology                     | Chemistry                    | A-G Science Elect.           | Civic/Econ or AP             |
| P.E. 1                      | P.E. 2                       | A-G Fine Art                 | Elective                     |
| Foreign Lang.               | Foreign Lang.                | Foreign Lang. (opt.)         | A-G Elective                 |
|                             |                              |                              | A-G Elective                 |

UC University / Cal Poly Schools / Some Private Universities Model

| <u>9<sup>th</sup> Grade</u> | <u>10<sup>th</sup> Grade</u> | <u>11<sup>th</sup> Grade</u> | <u>12<sup>th</sup> Grade</u> |
|-----------------------------|------------------------------|------------------------------|------------------------------|
| English 9 Honors            | English 10 Honors            | English 11 AP                | AP Lit & Comp.               |
| Geometry                    | Algebra 2                    | Trig/Pre-Calculus            | AP Calculus/AP Stats         |
| Health                      | World History AP             | US History AP                | Civics/Econo AP              |
| Biology                     | Chemistry                    | AP Science Elective          | AP Elective                  |
| P.E. 1                      | P.E. 2                       | A-G Fine Art                 | A-G Elective                 |
| Foreign Language            | Foreign Language             | Foreign Language             | A-G Elective                 |

**2017 – 2018**  
**UNIVERSITY OF CALIFORNIA**  
**A – G REQUIREMENTS**

*The courses are offered or have been offered at Lancaster High School and meet the requirements for admission to the University of California.*

**A – HISTORY - 2 years Required**

Civics  
 United State Government and Politics AP  
 World History                      World History (AP)  
 U.S. History                      U.S. History (AP)

**B – ENGLISH – 4 years Required**

English 9                      English 9 Honors  
 English 10                      English 10 Honors  
 English 11  
 English Language and Composition (AP)  
 English 12  
 English Literature and Composition (AP)  
 Expository Reading & Writing

**C – MATHEMATICS - 3yrs req. – 4 yrs. recommended**

Algebra 1                      Algebra 2  
 Calculus AB (AP)                      Calculus BC (AP)  
 Geometry                      Intro to Prob. & Statistic  
 Geometry/Trig                      Trig/Pre-Calculus  
 Statistics (AP)

**D – LABORATORY SCIENCE - 2 yrs. Lab req. 3 yrs. Recom.**

Anatomy/Physiology                      Astronomy  
 Biology    Biology (AP)                      Biology Honors  
 Chemistry                      Chemistry (AP)  
 Enviro. Science (AP)                      Marine Biology  
 Physics                      Physics 1 (AP)  
 Physics C: Mechanics AP

**E – LANGUAGE OTHER THAN ENGLISH – 2 yrs. req. 3 yrs. recom.**

Spanish 1    Spanish 2    Spanish 3  
 Spanish 1 Honors                      Spanish 2 Honors  
 Spanish Lang (AP)                      Spanish Lit (AP)  
 Spanish 1 & 2 for Spanish Speakers  
 French 1, 2, & 3

**F – VISUAL & PERFORMING ARTS – 1 yr req.**

3D Media Design 1    A'Capella Choir  
 Art 1                      Art 2  
 Adv. Theater Prod 2-4    Concert Band  
 Beginning Guitar  
 Drama 1, 2, 3, & 4  
 Intro to Film & Video Theory  
 Mixed Chorus  
 Multimedia Cont. Design1  
 Music Appreciation  
 Painting 1                      Painting 2  
 Photography 2  
 Show Choir                      Show Corps  
 Studio Arts: 2-D Design  
 Visual Imagery                      Wind Ensemble

**G – ELECTIVE - 1 year required**

Advanced Journalism  
 AVID 9                      AVID 12  
 Body Systems & Disorder  
 Creative Writing                      Criminal Justice  
 Computer Integrated Mfg.  
 Computer Science Principles (AP)  
 Digital Electronics                      Earth Science  
 Economics                      Economics Honors  
 Intro to Computers  
 Intro to Education                      Intro to Eng. Design  
 Intro to Mod Journ.                      Medical Science 1  
 Principles of Engineering  
 Psychology                      Psychology (AP)  
 Research (AP)                      Seminar AP  
 Sociology                      Student Gov. & Lead.  
 Veterinary Science

| <b>CSU/UC ADMISSION REQUIREMENTS AS OF 2017</b> |                        |
|---|------------------------|
| <u>"A – G" Subjects</u>                         | <u>#Years Required</u> |
| English   | 4                      |
| Math (Algebra 1/Geometry/Algebra 2)             | 3                      |
| History/Social Science (World/US)               | 2                      |
| Laboratory Science                              | 2                      |
| Foreign Language (2 yrs same language)          | 2                      |
| Visual/Performing (Art, Dance, Drama, Music)    | 1                      |
| Elective (from A – G subjects)                  | 1                      |

All grades in above subjects must be "C" or better

## STUDENT SERVICES

### GUIDANCE

Students are encouraged to visit with the counselors for personal guidance and for information on grades, study help, and testing programs. The counselors are available to discuss any home, school, or social concerns.

## STUDENT CODES OF CONDUCT

### ATTENDANCE

Student success in school is directly tied to attendance. Responsibility for attending class lies with the student.

#### Absences

If a student is absent from class, he or she should do one of the following within two days of returning to school:

1. Bring a note to the attendance office from a parent or guardian stating the date(s) of the absence and the reason(s) for the absence.  
OR
2. Have his or her parent or guardian call the attendance office and give the date(s) of the absence and the reason(s) for the absence.

**AN ABSENCE WILL NOT BE CLEARED WITHOUT A DOCTOR'S  
NOTE AFTER 5 SCHOOL DAYS.**

### ANTELOPE VALLEY HIGH SCHOOL DISTRICT

#### 5-Day Attendance Policy

1. After 5 periods or 300 minutes, whichever comes first, of unexcused absence in one class for one semester the student is considered to be on attendance probation and at risk of receiving no credit for that class. Unexcused absences are at-home suspension, truancy and absences for which no verifiable reason has been given by the parent or guardian.
2. Parents will be notified of this policy at the beginning of each school year or upon the enrollment of the student. Parents will be sent notification by mail of the number of unexcused absences their student has in each class at the following times: first quarter progress report, first quarter report card, second quarter progress report, third quarter progress report, third quarter report card, fourth quarter progress report. Notification of unexcused absences may be sent more frequently than outlined above or at differing times due to school block schedules.
3. A separate notification, warning of the possibility of receiving no credit for a class, shall be sent at the time a student reaches five unexcused absences or 300 minutes of unexcused absence, whichever comes first, in any class period.
4. Parents may clear, by note or phone call, any non-suspension or non-truant absence during a period of time not to exceed five school days after the occurrence of the absence. After the five-day window of opportunity a doctor's note indicating a diagnosis is required to clear an absence.
5. If a student is absent from school for a portion of the day for illness or a doctors visit, the parent or guardian must properly check the student out of school through the attendance office. If this procedure is not followed, the student's period absences may be marked as unexcused.

**5-Day Attendance Policy (continued)**

6. Students may opt to attend Voluntary Saturday School (VSS) for a minimum of four hours to clear absences which have not been cleared by a verifiable excuse. After successfully attending VSS the student will have the option of clearing one all-day unexcused absence or two unexcused period absences. Parent permission is required for the student to attend voluntary Saturday school.
7. Students are encouraged to attend VSS to reduce unexcused absences before they have reached the 5-day limit. Students must clear 1<sup>st</sup> semester absences via VSS prior to the start of the 4<sup>th</sup> quarter. 2<sup>nd</sup> semester absences must be cleared via VSS prior to the start of the summer school session. After the conclusion of 2<sup>nd</sup> semester additional sessions of VSS will be offered as needed.
8. Students attending Regional Occupation Program (ROP) classes are held to different attendance requirements as required by state education code. The ROP program will clarify those requirements.
9. The Superintendent is directed to establish procedures to implement this policy. Annually an evaluation of this policy shall be reported to the Board of Trustees.

**Voluntary Saturday School Program**

The Attendance Committee recognizes the need to allow an alternative attendance option in its new 5-day attendance policy. We hope that parents will be proactive in their student's attendance and take the responsibility to clear absences as they occur. The purpose of voluntary Saturday School is to allow students with all-day absences to engage in instruction on a Saturday in order to reduce the number of absences. Eligible types of absences to be reduced are any unverified, all-day type. Suspensions, and confirmed truancies.

1. A student may attend the program no more than five times during a semester.
2. The student must sign up for the program by no later than the Thursday, 3PM, prior to the Saturday school date. Parent permission by writing or verbal contact is needed for the student to attend voluntary Saturday school.
3. The Saturday school teacher will monitor the progress of the students who are voluntarily attending.
4. The Saturday school teacher will have the final decision as to whether the student receives credit for the day or no credit. This decision will be based upon the amount of work completed by the student. A student may be dismissed from Saturday school, with the loss of credit, due to inappropriate behavior.
5. The following Monday the Saturday school teacher will deliver to the administrator over the program a list of students who received credit for voluntary Saturday school.
6. Upon successful completion of the Saturday school the student will have one full-day of unverified absence re-coded in the computer attendance files to represent attendance to a voluntary Saturday program. This absence will now be considered excused and will no longer count against the student in relation to the 10-day attendance policy.
7. A student may not attend voluntary Saturday school for absences more than 20 school-days past.



## **OPERATION D.A.R.T**

### **Delinquency Abatement through the Reduction of Truancy**

To decrease chronic absenteeism, the Antelope Valley Union High School district is implementing a zero-tolerance, anti-truancy endeavor. This multi-agency program will be conducted in partnership with the Lancaster and Palmdale Stations of the Los Angeles Sheriff's Department along with the assistance of U-CAN (United Community Action Network), the Los Angeles County Probation Department, and the Juvenile Court of the Los Angeles County Superior Court.

Operation D.A.R.T., Delinquency Abatement through the Reduction of Truancy, is designed to decrease daytime crime and juvenile delinquency through a continual series of truancy sweeps. The truancy sweeps are intended to hold both student and their parents accountable for school absences.

As a parent or guardian, you are obligated to compel the attendance of your son or daughter at school. Failing to meet this obligation, a parent or guardian may be guilty of an infraction subject to prosecution within the judicial system pursuant to Education Code §48290.

To enforce this, Los Angeles County Sheriff's Deputies, or for that matter, all peace officers, may detain and question youth solely based on his or her "youthful appearance" to determine whether he or she is truant. Law enforcement officers are authorized and empowered to demand that a person give his or her name, address, proof of age, the name of a parent, guardian, or other custodial adult, and any other information reasonably necessary to determine whether such a person is in violation of daytime loitering laws.

### **Legal Absences**

**Under §48205 of the California Education Code, a pupil may be legally excused from school when an absence or tardy is:**

1. Due to his or her illness.
2. Due to quarantine.
3. For the purpose of having medical, dental, optometric, or chiropractic services rendered.
4. For the purpose of attending the funeral services of an immediate family member.
5. For the purpose of jury duty.
6. Due to illness or medical appointment of a child of whom the pupil is the custodial parent.
7. For justifiable personal reasons, including, but not limited to, an appearance in court, attendance at a funeral service, observance of a holiday or ceremony of his or her religion, attendance at religious retreats, or attendance at an employment conference, when the pupil's absence has been requested in writing by the parent or guardian and approved by the principal or designated representative pursuant to uniform standards established by the governing board.

### **Truancy and Daytime Loitering, Violations, and Fines**

**1st Violation:** \$225

**2nd Violation:** \$415 and possible delay or suspension of Driver's License

**3rd Violation:** \$605 and automatic delay or suspension of Driver's License

## TARDY POLICY

### The tardy policy at Lancaster High School is as follows:

- Teachers will implement this tardy policy as part of their classroom management.
- Tardies are tallied per semester and per individual class.
- After 5<sup>th</sup> Tardy Teacher will refer students name to CAW.
- Teachers will record classroom tardies and assign the following consequence:

The following are consequences for being tardy:

|                                |   |
|--------------------------------|---|
| <b>1<sup>st</sup> offense:</b> | Warning   |
| <b>2<sup>nd</sup> offense:</b> | Warning   |
| <b>3<sup>rd</sup> offense:</b> | Assign 1 hour of after school work/notify parents   |
| <b>4<sup>th</sup> offense:</b> | Assign 2 hours of after school work/notify parents  |
| <b>5<sup>th</sup> offense:</b> | Refer to Vice-Principal (Saturday School)   |
| <b>6<sup>th</sup> offense:</b> | Refer to CAW (Community Attendance Worker)<br>Possible Truancy citation (\$215) (determined by courts)                                  |
| <b>7<sup>th</sup> offense:</b> | Refer to CAW<br>Possible Truancy citation (\$305) and possible delay or suspension of student's Driver's License (determined by courts) |
| <b>8<sup>th</sup> offense:</b> | Refer to CAW<br>Possible Truancy Citation (\$710) and <u>automatic</u> suspension of Driver's License (determined by courts)            |

Continued offenses will be considered defiance of LnHS rules and expectations and students will be assigned additional discipline for defiance.

"No show" for assigned discipline related to classroom tardy:

If students do not complete the discipline assigned by the teacher, Security will conference with the student and assign the subsequent consequence in the chart above.

### Tardy Sweeps:

Periodically security will perform Tardy Sweeps. A tardy sweep will be initiated by an announcement over the PA System. At that time, teachers are to lock their classroom doors. Any students out of class will be gathered and processed by security. Student will receive discipline according to their discipline record & time of arrival. Students may receive a citation **even if it is their first tardy**. Student will be sent to class with a pass. Teachers are to mark the student tardy in Powerschool.

## LANCASTER HIGH SCHOOL STUDENT IDENTIFICATION CARDS 2017 -2018 School Year

*To improve school climate and safety, all students and staff will wear an identification badge at all times during the school day and at all school functions Implementation will be in effect for the 2017-2018 school year.*

- All students will be issued a picture student identification card during the first week of school.
- All students will be issued one lanyard or that connects to the student identification card.
- Lanyards will be “breakaways” for safety reasons
- **The badge is to be worn clearly visible at all times around the neck on a school-approved lanyard.**
- All students are required to be visibly wearing their identification cards in order to enter the school campus.
- Students who do not have their lanyards/identification cards with them are required to obtain a temporary “sticker” at that time.
- The school has developed a process for tracking and assigning discipline to students who have repeatedly violated this policy in an effort to have parents insure students wear their identification cards and/or to collect the money attached to the student charges. In addition, dress code sweeps will be conducted and students will receive disciplinary action for not complying with this policy.
- Replacement identification cards can be purchased for \$5.00. Replacement lanyards can be purchased for \$1.00
- In addition, **Temporary ID stickers must be obtained prior to going to class.** 1st period teachers will refer any students that do not have his/her identification card of temporary sticker.
- Students are required to wear the identification card throughout the entire school day and through the duration of school activities.
- Regular dress code sweeps will be conducted and students not wearing their ID cards may be assigned After School Work.
- Consequences for failing to wear student identification cards
  1. Obtain temporary sticker/Warning
  2. Obtain temporary sticker/Warning
  3. Obtain temporary sticker/Phone call to parent/guardian
  4. Obtain temporary sticker/After School Work
  5. Obtain temporary sticker/Saturday Work
  6. A \$6.00 charge will be placed on the student account and the student will receive a replacement identification card and lanyard refer to Vice Principal – Parent conference
  7. Continued offenses will be considered defiance of LnHS rules and expectations; students will be assigned additional discipline for defiance

Participation in extra-curricular activities may also be prohibited for students who continue to not follow this policy.

## LANCASTER HIGH SCHOOL DISCIPLINE POLICY

All students of Lancaster High School are expected to maintain high standards of behavior. It is the staff's expectation that students will learn and exhibit self-discipline and positive conduct. Rules to ensure appropriate behavior are established and enforced to maintain a safe and orderly environment that allows for optimum learning.

In addition to the laws of the State of California and the policies of Antelope Valley Union High School District, Lancaster High School has established the following general expectations for all students:

- **will demonstrate respect for others and others' property**
- **avoid causing disruptions to the educational process**
- **follow directions and respect authority of teachers and staff**
- **be prompt to all classes, avoiding tardiness**
- **remove hats inside all buildings**
- **refrain from chewing gum at all times on campus**
- **refrain from eating and drinking in classrooms**
- **follow the dress code**
- **stay away from the parking lot, and cars there, during the school day, whether or not students have a class. Student will receive Saturday School and/or Suspension from school**
- **refrain from loitering in the P. E. area and other off limit areas during the school day including lunch time.**
- **refrain from loitering on the Lancaster High School campus or any other school campus. Students are expected to leave campus within 15 minutes of dismissal.**
- **students are expected to exit school buildings and quads immediately after school.**
- **No gambling. Students may not bring dice on campus**
- **Students may not sell candy or any other unapproved items on campus**
- **Student may not bring any items on campus that are not for educational use.**

Student behavior will be monitored by the classroom teachers. Students choosing to violate school rules and procedures face the consequences as set forth in the Education Code 48900 and District Policy 5114.3. Teachers may refer students to the Administration Office immediately for behavior that endangers the safety of another or for repeated behavior violations for which previous corrective measures have not succeeded. Teachers may suspend students from a class for the day of the suspension and the next school day accompanied by appropriate documentation to the administration office. Teachers are expected to document all prior steps to correct inappropriate student behavior. If at any time a student needs to be restrained, teachers should call for security or the Administration Office. Students will not be left unattended.

**Per Education Code 48900 (p), students may be suspended or expelled for acts that take place while on school grounds, while going or coming to school, during the lunch period on or off the campus, and during or while going to or coming from, a school sponsored activity.**

The Education Code 48915 (a), (b) requires recommendation for a pupil's expulsion for the following reasons:

- **causing serious physical injury to another person**
- **possession of, selling or furnishing weapons, dangerous objects, or brandishing a knife**
- **unlawful sale of controlled substance**
- **robbery or extortion**
- **causing, threatening to cause, or threatening assault on school personnel**

## LANCASTER HIGH SCHOOL DISCIPLINE POLICY (continued)

Other infractions, which will require immediate referral to the Administration Office with specific suspension and/or expulsion recommendation, include:

- \* **assault, threats, hate crimes, sexual harassment, sexual assault**
- \* **possession of electronic devices (pagers, laser pens, cell phones, IPODs, etc.)**
- \* **possession of explosives (including imitation), imitation weapons**
- \* **disruption through group or gang activities**
- \* **fighting**
- \* **responding to, observing, inciting fights, verbal or physical altercations**
- \* **computer tampering**
- \* **drug or drug paraphernalia - students who are in first-time possession of drugs and/or drug paraphernalia will be required to enroll and complete in a alcohol and drug diversion program.**
- \* **false fire alarm**
- \* **receiving stolen property**
- \* **tagging/graffiti (see additional descriptions).**

Other violations of expected behavior include:

- \* **defiance of authority**
- \* **failure to follow directions**
- \* **disrespect for others**
- \* **chewing gum, food, or drink in the classroom**
- \* **tardiness**
- \* **wearing hats inside buildings, carrying Non LnHS hats**
- \* **non-compliance of dress code**
- \* **incomplete homework**
- \* **disruption of the educational process.**
- \* **being in possession of skateboard on campus. Skateboards must be left in the skateboard rack.**
- \* **loitering in off – limit areas (i.e. – P.E. area & athletic fields) including & during lunch time.**

***Individual students' citizenship grades for each class may reflect each student's discipline record.***

ALL DISCIPLINARY ACTION WILL BE IN ACCORDANCE WITH DISTRICT BOARD POLICY/ADMINISTRATIVE REGULATION 5144.

*Specific actions for offenses listed in Education Code 48900 are listed in the exhibit MINIMUM/MAXIMUM PENALTIES. (See Disciplinary Action Chart.)*

- **STUDENTS IN FIRST-TIME POSSESSION OF DRUGS AND/OR DRUG PARAPHERNALIA WILL BE REQUIRED TO ENROLL IN A SATURDAY ALCOHOL AND DRUG DIVERSION PROGRAM.**

## **DISTRICT DRESS CODE**

1. All students are required to wear appropriate footwear for school (no slippers).
2. All shirts and tops must cover the midriff at all times. The following are examples of clothing that is unacceptable: tank tops, strapless, spaghetti straps, off-the-shoulder, cut-out designs, low-cut shirts, bare-back, sheer or mesh clothing that does not have an appropriate blouse or shirt underneath, etc.
3. All pants and shorts must fit at the waist. No sagging or low riding will be permitted. Clothing must cover undergarments when sitting, standing, or bending.
4. Hemlines and slits on dresses, skirts, and shorts above mid-thigh are not acceptable.
5. Only school hats are acceptable and must be worn with brim forward. **STUDENTS ARE NOT ALLOWED TO CARRY NON – LnHS HATS.** Parents may pick up confiscated items at Security after 3:00 pm.
6. Clothing and hair accessories that are unsafe and/or dangerous are not permitted
7. Clothing or jewelry that depicts any "gang style" writing; illegal activity; sexually related or obscene gestures and material; tobacco; drugs; alcohol; or words, pictures, or phrases that depicts violence or intimidation may not be worn.
8. Any body piercing that presents a safety issue or major distraction will not be allowed.
9. Any clothing or styles of dress that may be construed to provoke fear, violence, or intimidation, including gang-related attire, is not acceptable.
10. All students are required to wear their ID Card on a lanyard or clip in a visible manner above the waist.

## **GANG DRESS POLICY**

1. Pants oversized at the waist are not allowed. These can be identified as pants that are folded in at the waist or belt line (e.g. students with a 32" waist should wear pants no larger than 32" waist).
  2. Wearing pants below the waistline (sagging) is not allowed.
  3. No gang-related jewelry, insignia, colors, paraphernalia, materials, apparel, clothing or attire may be worn or carried on campus or at school activities.
  4. Belt buckles with any initials are prohibited.
  5. Wearing an over-sized belt with one end hanging down is prohibited.
  6. Excessive color identifies worn in the color of red and/or purple, blue and/or green, black and/or gray, or orange (in combination with other gang attire) are prohibited.
  7. No gang-related hats, baseball-type caps or other gang-related head gear may be worn on campus or at school activities. Official school cap (i.e. approved by the principal) representing the current school of residence may be worn.
  8. Bandannas, red or blue belts, red or blue shoelaces, or rags that commonly signify gang identity by style or color are prohibited.
  9. Clothing, jewelry, paraphernalia or material which is obscene, sexually explicit or which depicts or suggests sexually-related or obscene gestures, pictures or wording or which promotes violence, the use/abuse of drugs, tobacco or alcohol may not be worn or carried on campus or at school activities.
  10. Shorts extending below the knee when worn with over-the-calf socks are prohibited. No pants can be worn with one leg up and one down.
  11. No student may wear articles of clothing jewelry, paraphernalia or accessories which pose a threat to the physical and/or emotional well-being and safety of the student or others on campus or at school activities.
  12. Shirts buttoned at the top and unbuttoned at the bottom are prohibited.
  13. Steel-toe combat style boots are prohibited.
  14. Gang or tagger-crew writing on shoes, clothes or body, backpacks or accessories are not permitted.
  15. Sports jerseys, other than school jerseys, will not be allowed.
  16. Clothing or articles of clothing (including, but not limited to gloves, bandannas, shoestrings, wristbands, jewelry) which are likely to provoke others to acts of violence or which are likely to cause others to be intimidated by fear of violence may not be worn on campus or at any school activity.
- In addition to these guidelines, students at Lancaster High School are not to wear clothing with holes or tears.**

***Sometimes You Need Some Help...***  
**(Emergency Numbers/Hotline Numbers)**

**Problems with drugs or alcohol?**

|  |                |
|--|----------------|
| AL-ANON (for families of alcoholics only)          | (661) 274-9353 |
| Alcoholics Anonymous                               | (661) 945-5757 |
| National Council on Alcoholism and Drug Dependency | (661) 948-5046 |
| Tarzana Treatment Centers of the Antelope Valley   | (661) 726-2630 |
| U-CAN Teen Help Line                               | (661) 948-3000 |

**Depressed? Thoughts of Suicide?**

|  |                |
|--|----------------|
| California Youth Crisis Line                 | (800) 843-5200 |
| Suicide Prevention Center (L.A. County Area) | (877) 727-4747 |
| Teen Line Hotline                            | (800) 852-8336 |

**Domestic Violence? Child Abuse? Runaway?**

|   |                |
|---|----------------|
| AV Youth & Family Services (all types of referrals) | (661) 949-1069 |
| California Missing Children Hotline                 | (800) 222-3463 |
| Children of the Night (24-hour runaway hotline)     | (800) 551-1300 |
| Covenant House Nineline (support for Teens)         | (800) 999-9999 |
| Domestic Violence Hotline                           | (661) 945-6736 |
| Los Angeles County Child Abuse Hotline              | (800) 540-4000 |
| National Runaway Switchboard                        | (800) RUN-AWAY |
|   | (800) 786-2929 |
| Sexual Assault Response Service (SARS)              | (661) 723-7273 |
| National Youth Crisis Hotline                       | (800) 448-3000 |

**Other Help Lines/Hot Lines**

|   |                |
|---|----------------|
| Police, Fire, Rescue, Medical (Emergency Number only)   | 911            |
| American Pregnancy Association Help Line                | (800) 672-2296 |
| Anonymous Crime Reporting (WE TIP)                      | (800) 782-7463 |
| A.V. Health Center (basic medical care)                 | (661) 723-4511 |
| A.V. Hope Center (HIV/AIDS Hotline)                     | (661) 945-8448 |
| Catalyst Foundation for AIDS/HIV Clinic                 | (661) 948-8559 |
| Lancaster Sheriff's Station (Non-Emergency Number)      | (661) 948-8466 |
| Palmdale Sheriff's Station (Non-Emergency Number)       | (661) 267-4300 |
| Palmdale Urgent Care (low/no fee services)              | (661) 273-2400 |
| Tarzana Primary Care Medical Center (basic health care) | (661) 723-4829 |

## **CLUBS AND ACTIVITIES AT LANCASTER HIGH SCHOOL**

The administration and faculty of Lancaster High School support the inclusion of extra-curricular and co-curricular activities as part of the educational process for students. We also understand the importance of academic achievement and the need to keep the education of our students as our highest priority. Students must maintain a level of academic success before they can participate in activities and the requirements listed below are meant to ensure that our emphasis is on education, and not to limit a student's participation.

The following are the requirements for students to participate in an extracurricular activity, such as a club, or dance, or extra curricular school event:

- Be enrolled in classes that earn the student at least 20 credits per semester.
- Have passing grades in the classes they are taking.
- Be on target with their credits earned toward graduation requirements.
- Have earned at least a 2.0 GPA. Quarter grades determine eligibility and have less than 3 unsatisfactory citizenship marks.  
End of quarter dates: 10/6/17, 12/15/17, 3/16/18, & 6/1/18
- May not have more than 10 hours of unexcused absences or trancies in two or more classes.
- Have a schedule of at least four (4) hours of class time (or 2 periods) per day to participate in an activity. In cases where an activity is scheduled for a Saturday, students should have attended at least four (4) hours of class time (or 2 periods) on the preceding Friday to participate.
- Students who travel with a club for an activity or field trip must complete and **Emergency Information Card** (pink card) signed by their parent.
- Students and parents/guardians are required to sign the **Club Activities Participation** form.

***The administration at Lancaster High School may revoke a student's eligibility should they have poor citizenship or attendance, or the student's behavior (prior or present) is of a nature considered not conducive to representing his/her school.***

### **District Board Policy (BP 6145.5)**

The Board of Trustees believes that student organizations reinforce the instructional program, give students practice in democratic self-government, and provide social and recreational activities. Student organizations also serve to honor outstanding student achievement and enhance school spirit and student's sense of belonging.

School sponsored student organizations must be organized at the school, have a certificated advisor, be composed completely of current student body members, and be approved by the Superintendent or designee in accordance with Board of Trustees policy. They shall hold the majority of their meetings at school and have a democratic plan for the selection of officers. Organization activities shall not conflict with the authority and responsibilities of school officials.



## CLUBS ON CAMPUS

The following is a list of clubs that have been active in the past and *may be* active during the 2017-2018 school year:

**Anatomy/Physiology Club**

**Animation Club**

**Art Club**

**ASB** (Associate Student Body)

**AVID** (Advancement Via Individual Determination)

**Band**

**Cheerleading**

**Chess**

**Choir**

**Class of 2018 - Seniors**

**Class of 2019 - Juniors**

**Cross Country Club**

**CSF** (See membership info below)

**Double Eagle Golf Club**

**Drama Club**

**Eagle Graphics Club**

**ImaginAsian**

**HERO Club**

**Hoopster**

**Hot Club**

**Interact Club**

**Key Club**

**Link Crew**

**Mathletes**

**Mix It Up Club**

**Mock Trial**

**Pep Club**

**Psychology Club**

**Robotics**

**Science Club**

**Speech & Poetry Club**

**Under God's Grace Christian**

**Yearbook**

**California Scholarship Federation (CSF)** is a statewide organization dedicated to encouraging academic achievement. **Membership** is based on grades earned the previous semester and must be renewed at the beginning (first three weeks) of each semester. Membership applications and qualifications are available in the activities office or from Ms. Beckerman in the Guidance Office. **Life CSF membership** and graduation in gold is earned by membership in CSF for 4 semesters beginning with grades earned during the sophomore year and including at least one semester based on grades earned during the senior year. For further clarification please see Ms. Beckerman in the Guidance office.

## Co-Curricular Programs

**Advanced Placement / College Prep Program:** The Lancaster High School Advanced Placement/College Prep Program is a supportive and inclusive college preparatory program for all students. It focuses on preparing students for success at CSU, UC, Community, or Private colleges by offering a combination of advanced work, team building, academic support, academic enhancement, and rigorous curricular paths. Students who complete the program will receive identification on both their transcripts and their diplomas. In addition to advanced enriched courses, students will attend special advanced study class, “festival evenings”, and field trips to local colleges.

**Air Force Junior ROTC Program:** This is a complete Air Force Junior ROTC program sanctioned by the United States Air Force emphasizing aerospace science and leadership education. The mission of AFJROTC is to “build better citizens for America”. The core values are Integrity first, Service before self, and Excellence in all “we do”. The goals are to instill cadets with the values of citizenship, service to the United States, personal responsibility, and a sense of accomplishment. This 4-year program includes the following curriculum: Frontiers of Aviation History, the Science of Flight, and the Exploration of Space and Management of the cadet’s corps. Leadership education, intercommunication skills, life skills, drill activities, and ceremonies are offered as well. Cadets of the program also serve the local community by volunteering for various school and community programs. Cadets are required to wear uniforms on day a week and are expected to abide by the AFJROTC honor code.

**AVID Program:** Advancement Via Individual Determination (AVID) is an academic, regularly-scheduled elective program which uses writing as a tool of learning, inquiry method, and collaborative grouping. The three main components of the program are academic instruction, tutorial support, and motivational activities that include tours of universities/colleges, and guest speakers. AVID is a school-wide approach to college access, specially targeting students in the “middle” by providing high expectations, encouragement, day-to-day support, and a vision of college acceptance and graduation. AVID involves students in a strong group of peers and adults who share a commitment to academic achievement and who work together to help the group succeed.

**Pre-Engineering Pathway and Robotics Program:** This program will provide a rigorous combination of academic and hands-on learning in the area of Engineering. Courses include Engineering Design, Digital Electronics, and Principles of Engineering. The specific curriculum is developed and maintained by the National Alliance for Pre-Engineering Programs. A local consortium of industry and universities supports the program. The Robotics program is an extra-curricular program where students participate in building and completing a robot at the national level.

## LANCASTER HIGH SCHOOL ATHLETICS

Your support of our athletic program is vital and greatly appreciated. LnHS offers students extensive opportunities to participate in interscholastic athletics. LnHS is a member of the Golden League, as well as the California Interscholastic Federation (CIF) Southern Section.

| <b>FALL SPORTS</b><br>Practice begins August  | <b>WINTER SPORTS</b><br>Practice begins November                    | <b>SPRING SPORTS</b><br>Practice begins February  |
|---|---|---|
| Boys' and Girls' Cross Country<br>Football<br>Girls' Tennis<br>Girls' Volleyball<br>Girls' Golf | Boys' and Girls' Basketball<br>Boys' and Girls' Soccer<br>Wrestling | Baseball<br>Softball<br>Boys' Tennis<br>Boys' Golf<br>Boys' Volleyball<br>Boys' and Girls' Swimming<br>Boys' and Girls' Track and Field |

***Prior to the date that practice begins, a coach may have tryouts for students who did not participate in the sport at Lancaster High School in the previous school year.***

In order to participate in any sport, the student must meet the following requirements:

1. District Requirements
  - a. 2.0 grade point average each quarter and semester grading period
  - b. Maintain minimum progress toward graduation
  - c. Maintain acceptable citizenship
2. Be eligible under the rules of the California Interscholastic Federation:
  - a. May not have reached his/her 19<sup>th</sup> birthday prior to June 15<sup>th</sup> of the current school year. (June 15, 2017 in the 2017-2018 school year.)
  - b. Have attended high school not more than eight semesters.
  - c. Have passed with at least a “C” (2.0) average 20 credits of work for the prior grading period of which only 5 credits may be Physical Education; be passing in 20 credits of new work for the current grading period.
  - d. Have met residential requirements. Transferring from one school to another may affect your eligibility under the CIF Southern Section rules.
  - e. Not compete on any outside team in the same sport during the school season of that sport.
3. Pass a physical examination within the previous 12 months.
4. Obtain the written permission from parent or guardian to compete and travel by school district transportation.
5. Be covered by or obtain athletic injury insurance.
6. An athlete may not participate in sports if he/she has an outstanding debt (fails to return, or losses equipment/ uniforms, or fails to pay or return any fund raising monies) with ASB

We believe the highest potential of sports is achieved when participants are committed to pursuing victory with honor.

Our coaches are all dedicated to the growth of the Lancaster High School athletes in character, scholastics and athletic performance.

## **CAMPUS POLICY**

Students & Families,

Please be advised that the safety of students and staff is of the utmost importance at Lancaster High School. To ensure the safety of our staff and students, the following procedures and guidelines must be followed:

1. Lancaster High School is a “closed campus.”
  - a. Only Students with senior Lunch passes (students must apply each semester of their senior year in the Activities office), passes indicating that the student has a shortened schedule, or pink off-campus passes may leave the campus during the school day. Students are not allowed to go to his/her car to obtain items during the school day.
  - b. During the school day students are required to enter and exit the campus through the main student doors located on the North side of the campus near the student parking lot. Students are not to exit the campus at any time through the main lobby doors, unless accompanied by a parents/guardian.
  
2. Parents and visitors are required to enter the campus through the lobby located at the front of the campus off of 32<sup>nd</sup> Street West. Parents and visitors must check in with the switchboard operator in the lobby and obtain a Visitor’s pass. If parents are checking students out of school for period or the day, they must wait for the student at the Attendance Office. Remember that parents/guardians must present identification to obtain any information about students and/ or check them out of school.

**Antelope Valley Union High School District  
BP 1310.1 (a)**

## **CIVILITY POLICY**

If any member of the public uses obscenities or speaks in a demanding, loud, insulting and/or demeaning manner, the administrator or employee to whom the remarks are directed will admonish the speaker to communicate civilly. If corrective action is not taken by the abusing party, the District employee will verbally notify the abusing party that the meeting, conference or telephone conversation is terminated and, if the meeting or conference is on District premises, the offending person will be directed to leave promptly.

When an individual is directed to leave under such circumstances, the Principal or designee shall inform the person he/she will be guilty of a misdemeanor in accordance with the California Education Code 44811 and Penal Codes 415.5 and 626.7, if he/she reenters any District facility within 30 days after being directed to leave, or within 14 days if the person is a parent/guardian of a student attending that school. If any individual refuses to leave upon request or returns before the applicable period of time, the Principal or designee may notify law enforcement officials.

